

**KITTITAS COUNTY
 WASHINGTON
 PLAT
 P-06-14**

**CERTIFICATE OF
 COUNTY TREASURER**
 I HEREBY CERTIFY THAT THE TAXES AND ASSESSMENTS
 ARE PAID FOR THE PRECEDING YEARS AND FOR THIS YEAR
 IN WHICH THE PLAT IS NOW TO BE FILED.

DATED THIS 23 DAY OF July, A.D., 2008.

M. Wibbelman
 KITTITAS COUNTY TREASURER

KITTITAS COUNTY ENGINEER

EXAMINED AND APPROVED THIS 11 DAY OF
June, A.D., 2008

[Signature]
 COUNTY ENGINEER

COUNTY PLANNING DIRECTOR

I HEREBY CERTIFY THAT THE PLAT OF _____
 HAS BEEN EXAMINED BY ME AND FIND THAT IT CONFORMS
 TO THE COMPREHENSIVE PLAN OF THE KITTITAS COUNTY
 PLANNING COMMISSION.

DATED THIS 4th DAY OF August, A.D., 2008.

[Signature]
 KITTITAS COUNTY PLANNING DIRECTOR

**KITTITAS COUNTY
 HEALTH DEPARTMENT**

I HEREBY CERTIFY THAT THE PLAT OF Meadow Ridge
 HAS BEEN EXAMINED BY ME AND I FIND THAT THE SEWAGE
 AND WATER SYSTEM HEREIN SHOWN DOES MEET AND
 COMPLY WITH ALL REQUIREMENTS OF THE COUNTY HEALTH
 DEPARTMENT.

DATED THIS 7 DAY OF July, A.D., 2008

[Signature]
 KITTITAS COUNTY HEALTH OFFICER

CERTIFICATE OF COUNTY ASSESSOR

I HEREBY CERTIFY THAT THE PLAT OF BELL CREEK
 HAS BEEN EXAMINED BY ME AND I FIND THE PROPERTY
 TO BE IN ACCEPTABLE CONDITION FOR PLATTING

DATED THIS 23rd DAY OF July, A.D., 2008

C. Adams
 KITTITAS COUNTY ASSESSOR

**CERTIFICATE OF BOARD OF
 COUNTY COMMISSIONERS**

EXAMINED AND APPROVED THIS 5th DAY OF
August, A.D., 2008

[Signature]
 BOARD OF COUNTY COMMISSIONERS KITTITAS COUNTY,
 WASHINGTON BY CHAIRMAN - VICE

ATTEST:
[Signature]
 CLERK OF THE BOARD

ORIGINAL PARCEL DESCRIPTION

LOT B-3, OF K.M. SHORT PLAT, KITTITAS COUNTY SHORT
 PLAT NO. 05-52, AS RECORDED JANUARY 26, 2006, IN
 BOOK H OF SHORT PLATS, PAGES 187 AND 188, UNDER
 AUDITOR'S FILE NO. 200601260040, RECORDS OF KITTITAS
 COUNTY, STATE OF WASHINGTON; BEING A PORTION OF LOT
 11-B, BROOKSIDE TRAILS WEST LARGE LOT SUBDIVISION AS
 PER PLAT THEREOF RECORDED IN BOOK 8 OF PLATS,
 PAGES 229 AND 230, IN THE COUNTY OF KITTITAS, STATE
 OF WASHINGTON.

LOT B-4, OF K.M. SHORT PLAT, KITTITAS COUNTY SHORT
 PLAT NO. 05-52, AS RECORDED JANUARY 26, 2006, IN
 BOOK H OF SHORT PLATS, PAGES 187 AND 188, UNDER
 AUDITOR'S FILE NO. 200601260040, RECORDS OF KITTITAS
 COUNTY, STATE OF WASHINGTON; BEING A PORTION OF LOT
 11-B, BROOKSIDE TRAILS WEST LARGE LOT SUBDIVISION AS
 PER PLAT THEREOF RECORDED IN BOOK 8 OF PLATS,
 PAGES 229 AND 230, IN THE COUNTY OF KITTITAS, STATE
 OF WASHINGTON.

TAX PARCEL NO. 952185, 952186, 952825,
MAP NO. 20-15-26060-0003, -0004, 0005, 0006
 OWNER: HIGHMARK RESOURCES, LLC.
 206 W. FIRST STREET
 CLE ELUM, WA 98922

VOL./PAGE
11-159

PORTION OF
 NW 1/4 NE 1/4, SEC 26, TWN 20, RGE 15E, W.M.

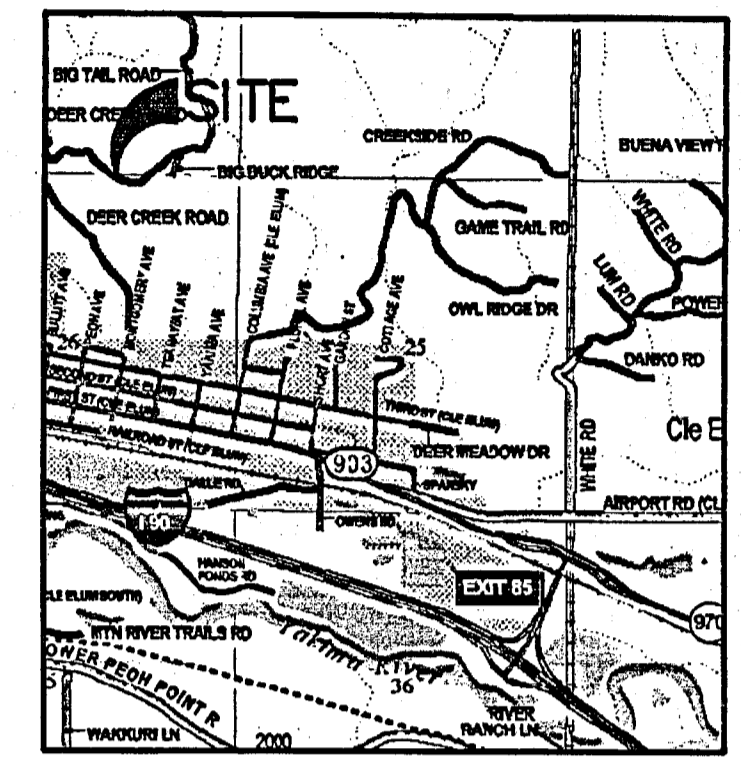

VICINITY MAP
 NTS

DECLARATION

KNOW ALL MEN BY THESE PRESENTS THAT WE THE UNDER-
 SIGNED OWNER(S) IN FEE SIMPLE OF THE DESCRIBED REAL
 PROPERTY, DOES HEREBY DECLARE THIS PLAT AND DESCRIPTION
 AND IN LIEU OF DEDICATION OF ROADS HEREBY GRANTS
 FOREVER UNTO ALL LESSEES OF LOTS IN THIS PLAT AND ALL
 FUTURE PLATS IN THIS PLAT AN UNDIVIDED INTEREST IN ALL
 ROADS SHOWN AS PRIVATE ROADS.

IN WITNESS WHEREOF, WE HAVE SET OUR HANDS THIS
29 DAY OF JULY, A.D., 2008.

[Signature] SEAN NORTHROP
 NAME

NAME

NAME

NAME

ACKNOWLEDGEMENT

STATE OF Washington
 COUNTY OF Kittitas) SS

I CERTIFY THAT I KNOW OR HAVE SATISFACTORY EVIDENCE THAT
SEAN. C. NORTHROP

SIGNED THIS DEDICATION AND ON OATH STATED THAT
 (HE/SHE) WAS AUTHORIZED TO EXECUTE THE INSTRUMENT AND
 ACKNOWLEDGED IT AS THE
Managing Member of Highmark Resources LLC
 TO BE THE FREE AND VOLUNTARY ACT OF SUCH PARTY FOR
 THE USES AND PURPOSES MENTIONED IN THE INSTRUMENT.

DATED 7/29/08
 SIGNATURE OF [Signature]
 NOTARY PUBLIC
 PRINTED NAME OF Jennifer Ewart
 NOTARY PUBLIC
 TITLE Notary
 MY APPOINTMENT EXPIRES 2/19/2012

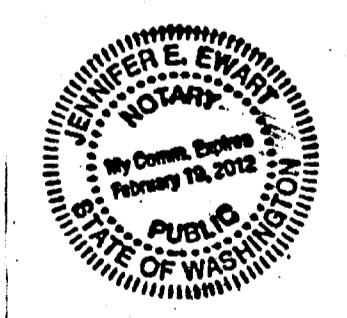

P: 06047.dwg \3\plot\Final Plat\01-PP6047.dwg 6/5/2008 12:11:35 PM PDT

RECORDER'S CERTIFICATE

FILED FOR RECORD THIS 5 DAY OF AUGUST, 2008 AT 2:00
 IN BOOK 11 OF SURVEYS PAGES 159 AT THE REQUEST OF
 GEODATUM, INC.

[Signature]
 COUNTY AUDITOR

SURVEYOR'S CERTIFICATE

THIS MAP CORRECTLY REPRESENTS A SURVEY MADE
 BY ME OR UNDER MY DIRECTION IN CONFORMANCE
 WITH THE REQUIREMENTS OF THE SURVEY RECORDING
 ACT AT THE REQUEST OF HIGHMARK RESOURCES, LLC.
 10 MARCH, 2006

[Signature]
 CERTIFICATE NO.: 31976
 EXPIRES: 07-10-09

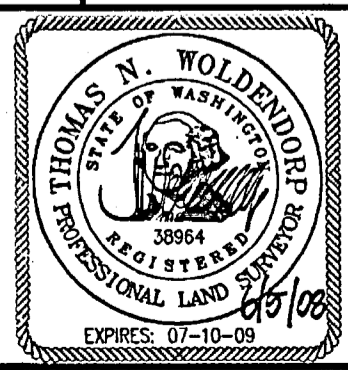

MEADOW RIDGE PLAT

HIGHMARK RESOURCES, LLC.
 206 W. FIRST STREET
 CLE ELUM, WA 98922

© 2008, GEODATUM, INC., ALL RIGHTS RESERVED

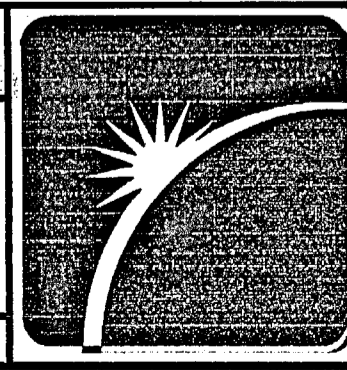

GeoDatum
 SURVEY - CIVIL - STRUCTURAL

1505 NW Mall Street
 Issaquah, WA 98027
 (425) 837-8083

NEIGHBORING OWNERSHIP

PARCEL NO. 18325
 MAP NO. 20-15-26010-0010
 CORY W. ANDRUS
 P.O. BOX 785
 CLE ELUM, WA 98922

PARCEL NO. 13530
 MAP NO. 20-15-23000-0005
 JAMES A. MUHLBEIER
 21403 SE 16TH PLACE
 SAMAMISH, WA 98075

PARCEL NO. 19159
 MAP NO. 20-15-23051-0003
 CLE ELUM HOMESTEAD, LLC
 P.O. BOX 654
 PORT ORCHARD, WA 98366

PROJECT#: SHEET: 1
 2006-047 OF: 2

www.geodatum.com